



Altadale Lezayre Road, Ramsey, Isle Of Man, IM7 2AJ
Asking Price £499,950

- Spacious single-level living with three generous double bedrooms and well-proportioned reception rooms.
- Ample parking and garage, providing practicality and convenience.
- Beautifully maintained gardens to the front and rear, offering exceptional privacy and a tranquil outdoor setting.
- Fantastic attic space with further potential, ideal for storage or possible extension (subject to planning).
- Bright conservatory off the living room, perfectly positioned to enjoy natural light and views of the garden.



Altadale on Lezayre Road is a true gem, offering spacious single-level living in a highly convenient location close to local amenities. Set within beautifully maintained gardens to both the front and rear, the property enjoys excellent privacy and lovely views from the rear, creating a peaceful setting despite being just moments from everything you need.

The accommodation is well proportioned throughout and begins with a welcoming entrance hall which leads to three generous double bedrooms and a family bathroom. The hallway then opens into a bright and comfortable living room, with a conservatory perfectly positioned just off this space to maximise natural light and bring the outdoors in.

Further reception space is provided by a versatile split reception room which could easily be utilised as a cosy snug alongside a dining area, located just off the kitchen. The kitchen itself is well placed for everyday living and is complemented by a separate utility room.

Externally, the property continues to impress with ample parking, a garage and beautifully cared-for gardens. The rear garden is the true showstopper – a wonderfully private and tranquil space that has been maintained to a very high standard, creating the feeling of a rural retreat while remaining just around the corner from local amenities.

Additional potential can be found within the generous attic space which currently provides excellent storage, with scope for further development or extension of the main build, subject to the necessary planning consents.

Altadale truly ticks the boxes for those seeking comfortable, spacious living, beautiful surroundings and privacy, all within an ideal and convenient location.













Altadale Lezayre Road, Ramsey, Isle Of Man, IM7 2AJ



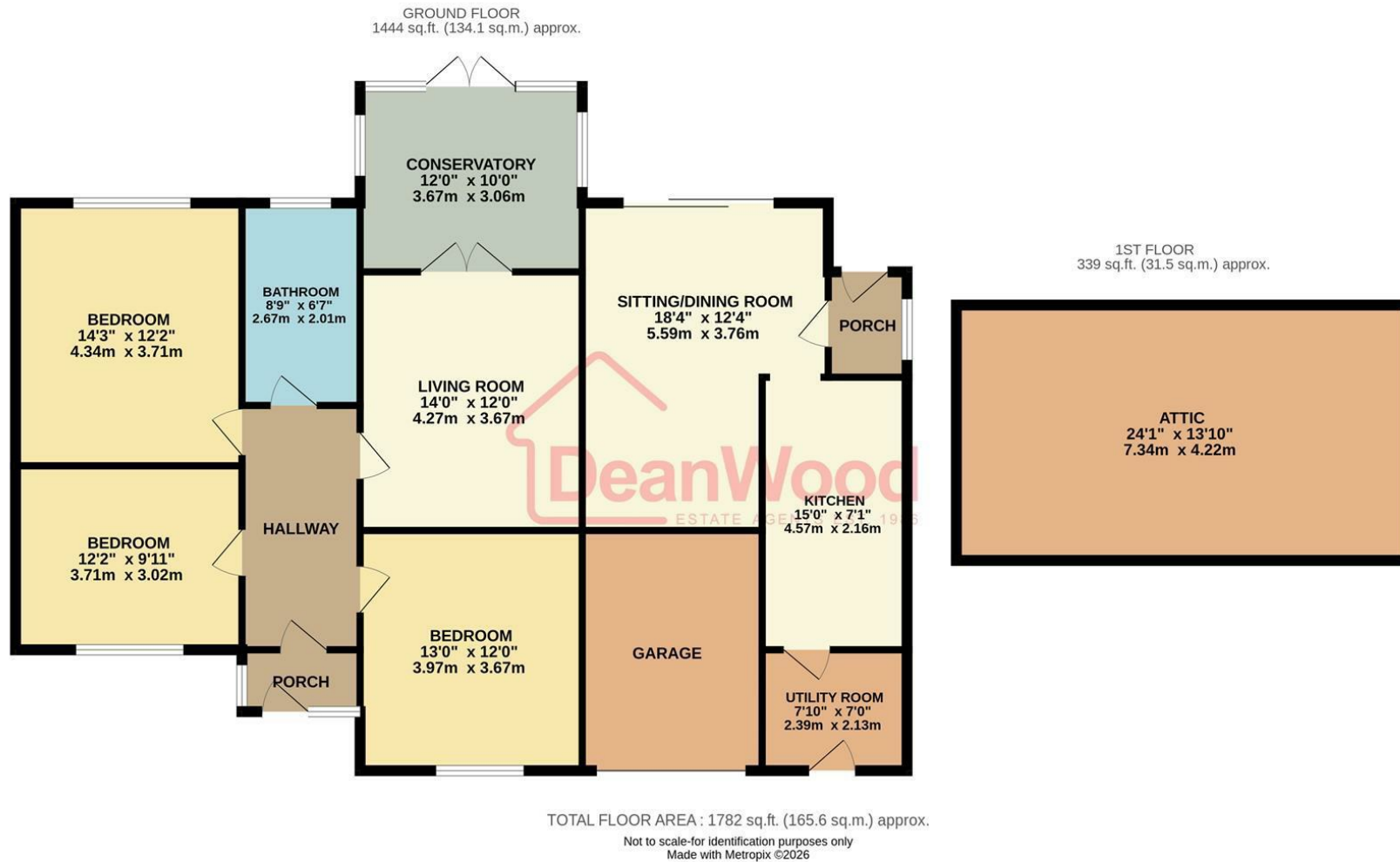

DOUGLAS

37 VICTORIA STREET
DOUGLAS
ISLE OF MAN IM1 2LF

T 01624 620606
F 01624 677363
E info@deanwood.co.im

CASTLETOWN

COMPTON HOUSE
9 CASTLE STREET CASTLETOWN
ISLE OF MAN IM9 1LF

T 01624 825995
F 01624 825996
E castletown@deanwood.co.im

RAMSEY

LEZAYRE HOUSE
87 PARLIAMENT STREET
RAMSEY ISLE OF MAN IM8 1AQ

T 01624 816111
F 01624 816588
E ramsey@deanwood.co.im

These particulars are for information purposes only. They do not constitute or form any contract nor should any statement contained herein be relied upon as a representation of fact. Neither the vendor nor DeanWood Agencies Limited ('the firm'), nor any officer or employee of the firm accept liability or responsibility for any statement contained herein. The vendor does not by these particulars, nor does the firm, nor does any officer or any employee of the firm have any authority to make or give any representation or warranty whatsoever as regards the property or otherwise. It is the sole responsibility of any person interested in the property described in these particulars to make all proper enquiries and searches to verify the description of the property and all other particulars herein.

FOR MORE PROPERTIES VISIT OUR WEBSITE @ deanwood.im